



Homed:In

18 Station Road, Southwater, RH13 9HQ



Station Road

Southwater, Horsham, RH13 9HQ

Price Guide £460,000

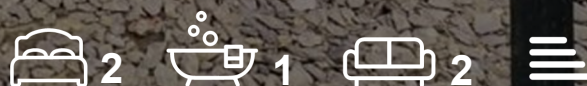

Station Road



Description

A truly rare and unique period cottage, situated right in the heart of this popular village, surrounded by shops, restaurants, schools, the Country Park and more.

- Central Location Beside Bus Routes, Shops and Country Park
- 120 ft Garden
- Large Loft Ideal for Extension
- 7 Minute Drive to Horsham
- New Kitchen and Boiler
- Rare Edwardian Home from 1907, Original Features
- Over 1,030 Sq Ft Floorplan including 4.8M Bedroom
- 30 Second Walk to Restaurants, Supermarket and Shops
- Gorgeous Log Burner
- VIDEO TOUR IN TAB OR AT OUR WEBSITE





Floor Plan

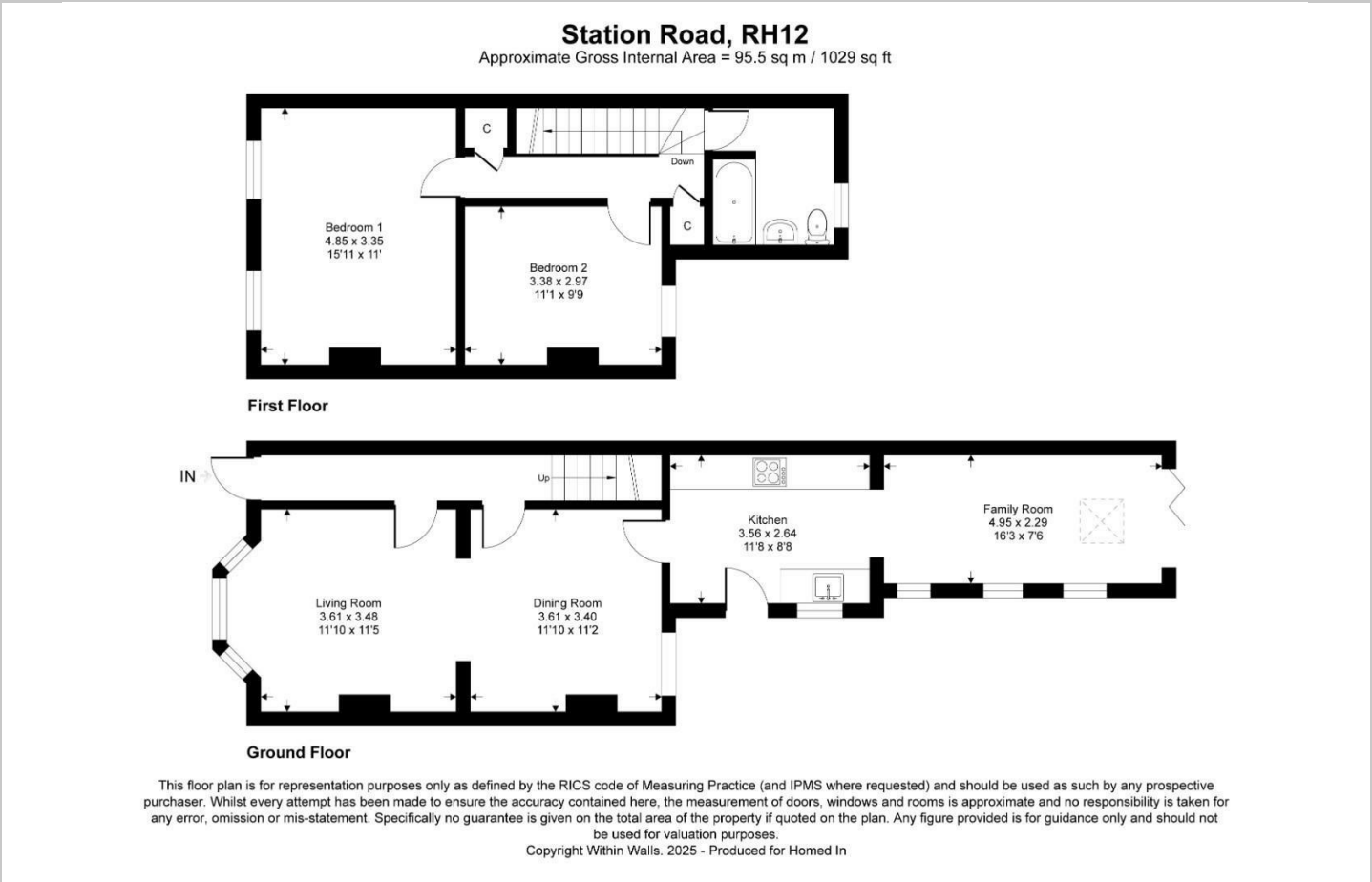

Area Map

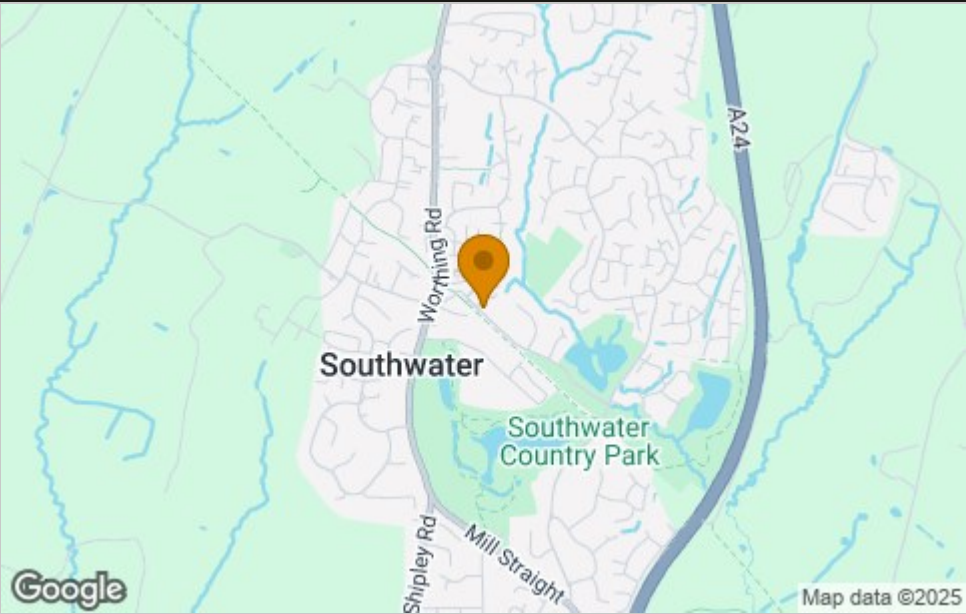

Viewing

Please contact our Horsham Office on 01403 597595 if you wish to arrange a viewing appointment for this property or require further information.

These particulars, whilst believed to be accurate are set out as a general outline only for guidance and do not constitute any part of an offer or contract. Intending purchasers should not rely on them as statements of representation of fact, but must satisfy themselves by inspection or otherwise as to their accuracy. No person in this firms employment has the authority to make or give any representation or warranty in respect of the property.

Energy Efficiency Graph

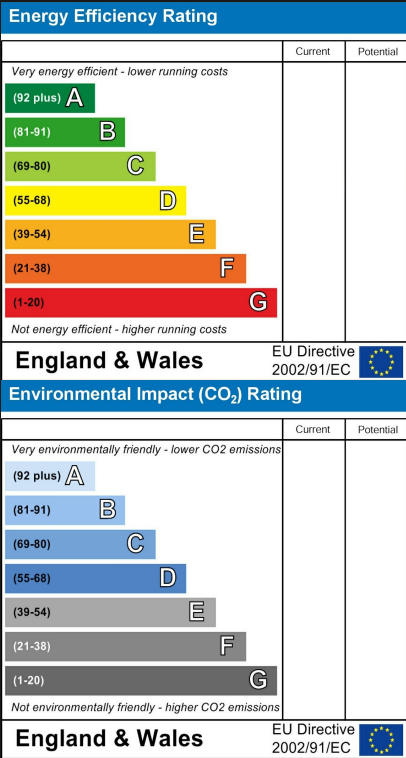

To GET A FREE VALUATION Call us on: 01403 597595 or email us at: info@homedin.co.uk